

MODULAR WINE SERVER



One thing that really attracted me to this wine rack is its modular design. Besides the great stand-alone project you see directly above, it's just as easy to expand it into the wine server or buffet shown at left.

But it isn't just for storing wine. You can use it as a foundation for a number of storage options. Building two or more of these basic units allows you to combine them in different ways. For starters, you can stack them one on top of another, or arrange them side by side — you can even do a combination of both if you'd like. By adding a new base for support or altering the interior design, you can change the function and appearance significantly.

The most interesting part of this countertop wine rack is the interlocking gridwork of dividers that separates the bottles of wine. The grid is really quite easy to make and assemble. And since the dividers aren't glued together, finishing all the parts is a snap. But before you get to finishing the divider assembly, you'll need to build the case and base that holds it.

OVERALL DIMENSIONS: 19¹/₈"W x 12⁵/₈"D x 36¹/₈"H

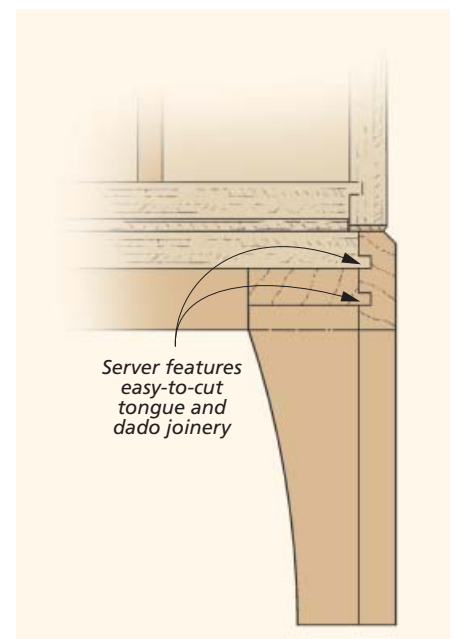
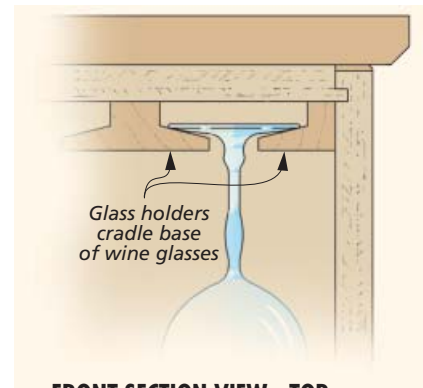
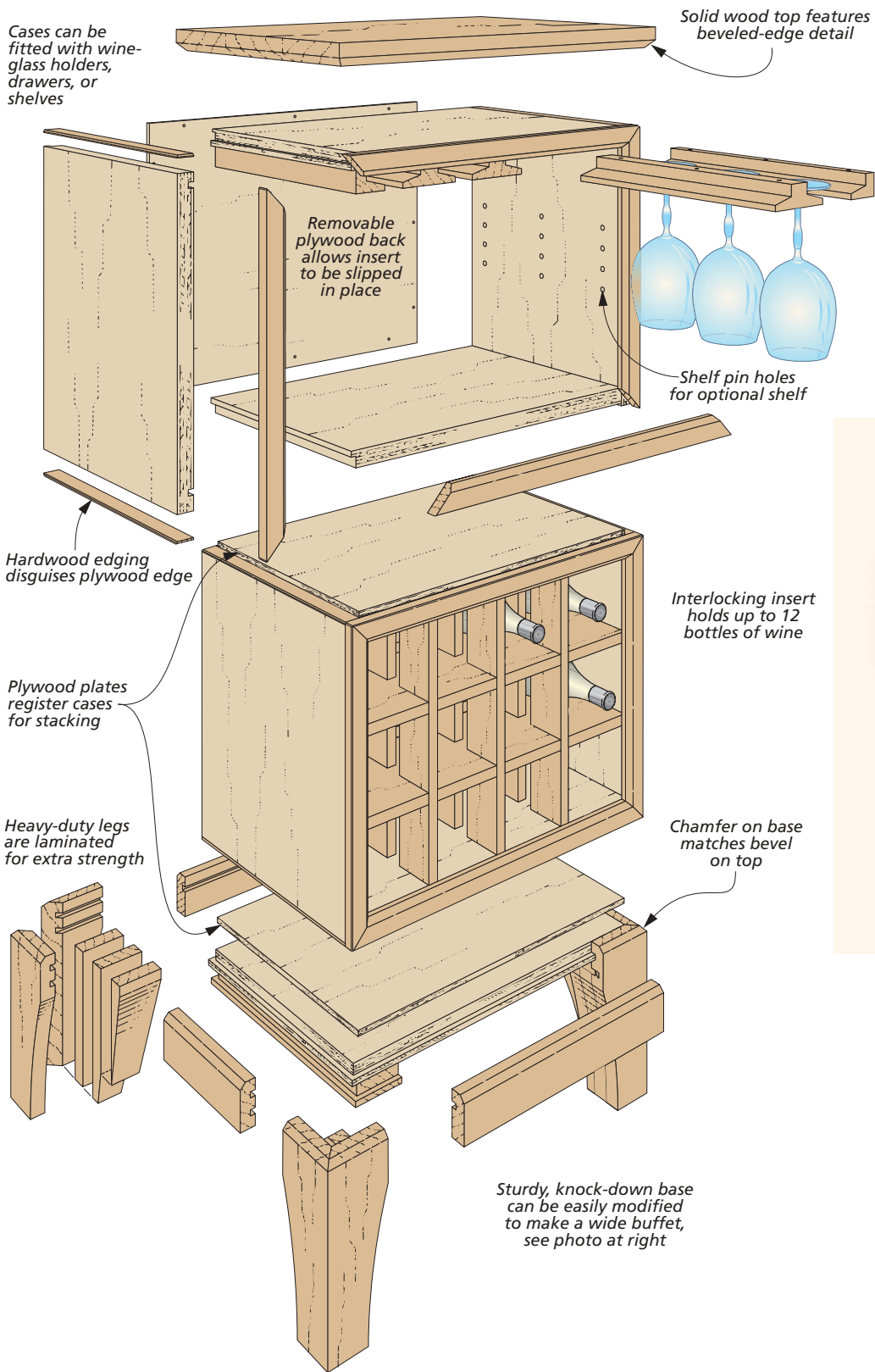

assemble the **CASE**

CASE JOINERY. The joinery for the case is a simple tongue and dado, but the key to the design is where the dados are located. You'll notice that the top and bottom dados are different distances from the ends of each side (detail 'c').

What this does is recess the bottom to provide a space for a positioning plate that's used when stacking another case on top. (You can see how this works by referring to page 8). At the top, the panel sits proud to allow for some hardwood edging that will cover up the plys, as in detail 'c.'

Once you've cut the dados in the *side panels (A)*, you can rabbet the ends of the

top and bottom panels (B, C) to fit. Then, before assembling the case, cut a rabbet along the back edge of the top and sides to accept the 1/4" plywood back that'll be added later (detail 'b').

For a sure way to square things up when you assemble the case, check out the box below.

PANEL EDGING & TRIM. With the case assembled, you're ready to add the *panel edging (D)* that covers up the plys on the top and bottom of the sides, like you see in detail 'c.' Then you can add the *trim pieces (E, F)*. You'll notice in the drawing



▲ **Countertop Wine Rack.** The case you build here can also be used as a stand-alone wine rack for your countertop.

above that the top and side trim form a lip to keep the dividers in place, while the bottom trim is flush with the bottom panel (detail 'a').

TOP. Next, you can make the *top (G)*. After cutting a 3/8" bevel along all four edges, just screw it in place.

Shop Tip: A Square and Smooth Case

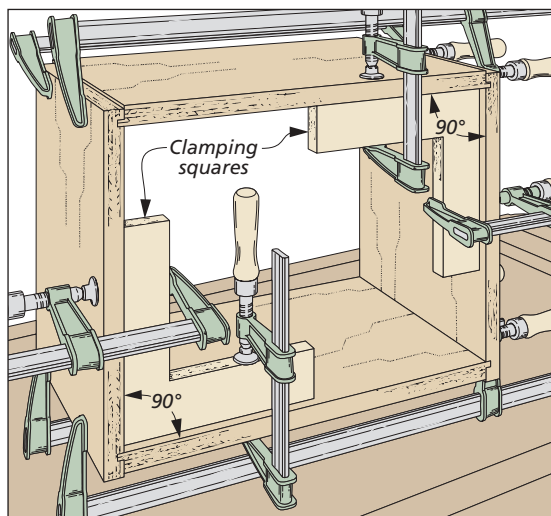

Square the Case. L-shaped corner clamping squares (drawing at left) ensure a 90° corner joint.

Edge Strip Sanding Block. The simple sanding block shown below eliminates the possibility of cutting into the plywood veneer when sanding the edging strip.

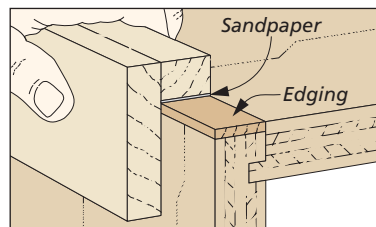

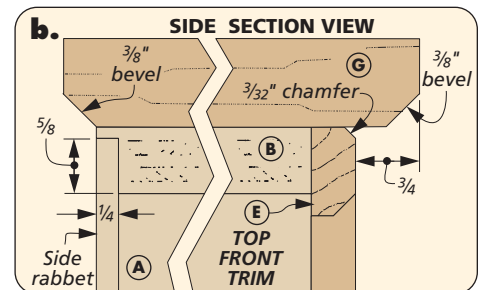
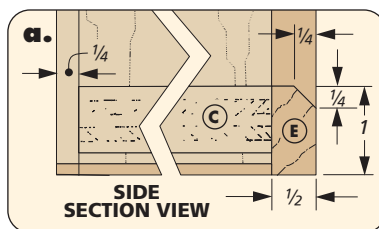
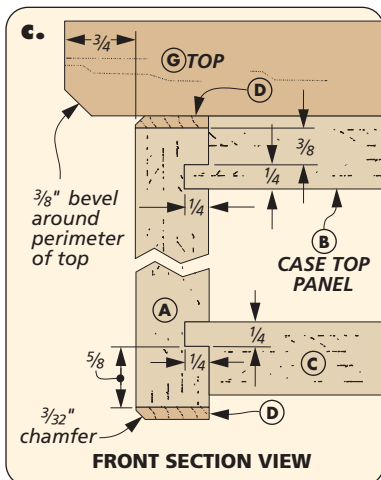
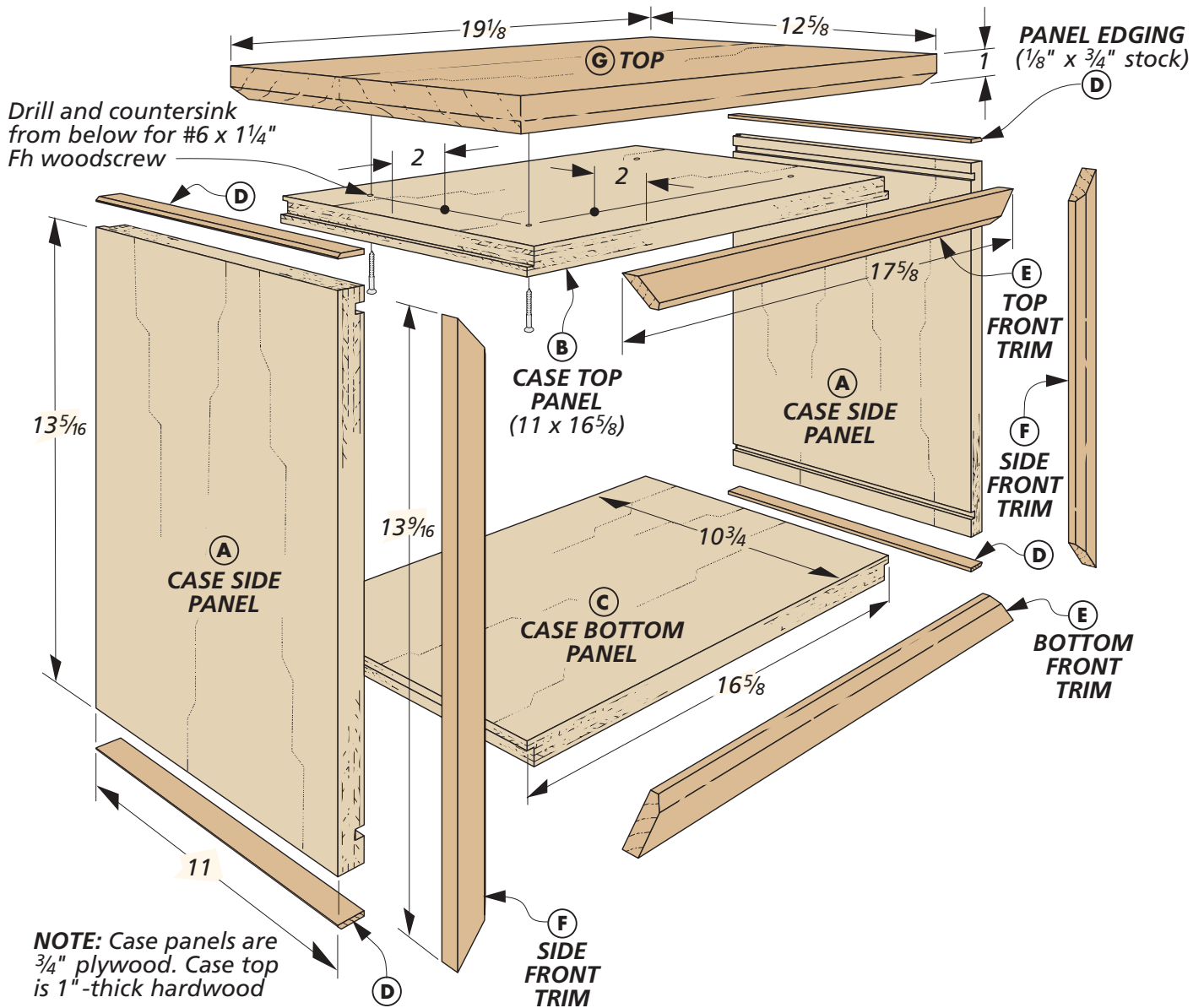

making the DIVIDERS

At first glance, the divider assembly shown at right appears more difficult to build than it actually is. But it's really nothing more than making a few different size slats and then cutting identical notches in each one.

SOLID ASSEMBLY. The notches are the key to forming a solid assembly when you fit the dividers together. For a good, tight fit, you'll need to accurately locate and size each notch. But don't worry, there are a couple tips to ensure that everything comes out just right.

CUTTING THE NOTCHES. The table saw and a dado blade make quick work of cutting identically sized notches. You can learn more about getting a perfect fit between the notches and slats by making a test notch and then planing your stock to match. There's more about this on page 12.

To ensure that the locations of all the notches shown in the drawing at right are consistent, it's a good idea to make a reference mark on the bottom of each slat before you start. See how I did this below.

You'll also see a couple other handy tips in the drawings for cutting clean, crisp notches — like backing up the workpiece

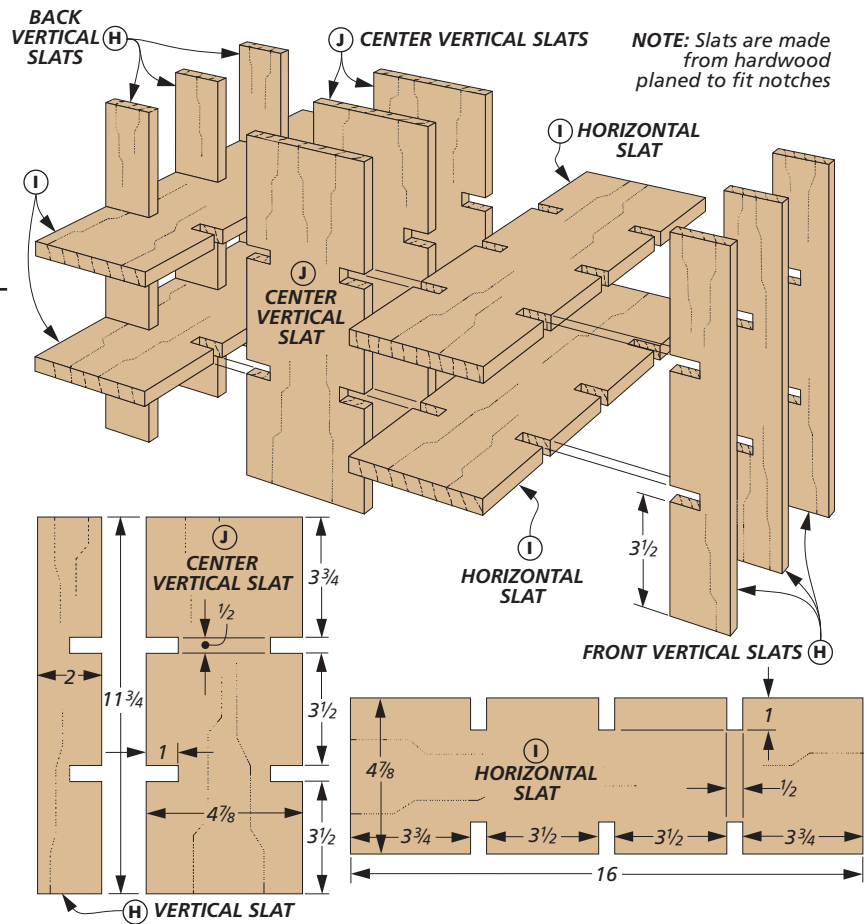

with an auxiliary fence to prevent chipout.

Another good tip to help accurately reference the bottom of each slat is to use the rip fence as a stop.

I know, you're not supposed to use the rip fence and the miter gauge at the same time. But the cuts you make for each notch don't go all the way through the workpiece — so it's okay to do this.

DIVIDER ASSEMBLY. Once you have all the pieces, you can assemble the dividers and make a test fit in the case. After making any tweaks for a smooth sliding fit, you can disassemble the dividers and set them aside until you're ready to apply a finish.

All that's left to do now is build the base and add the back that keeps the divider assembly in place.

How-To: Interlocking notches

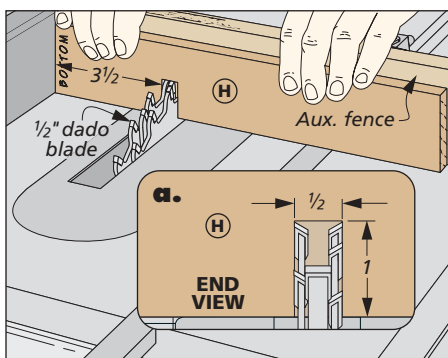

Slat Bottom Notches. Cut notches at the bottom of the vertical front and back slats as well as the vertical center slats.

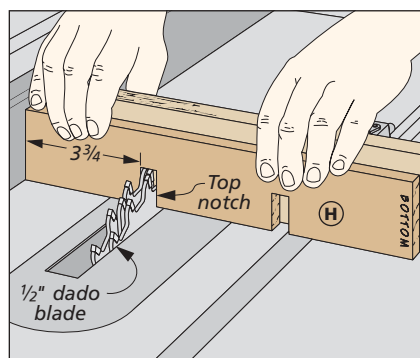

Slat Top Notches. Notch the top of the vertical front and back, vertical center slats and top and bottom of horizontal slats.

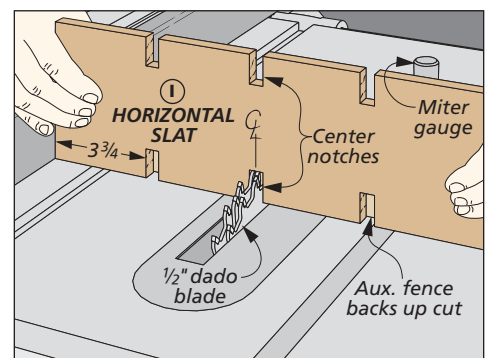

Horizontal Slat Center Notch. Finally, cut the center notches of each of the horizontal slats at the centerline of the slat.

completing the BASE

The wine rack sits on a base made by wrapping hardwood aprons around a plywood panel. This provides a stable support for setting the rack on a countertop, a tabletop, or anywhere else you might want to locate it.

APRONS. I started on the base by cutting the *front/back* (K) and *side* aprons (L) to final width. But I left them a little long. This way, I could cut them for a perfect fit later.

To join the aprons to the panel, you'll need to cut a groove along the top inside edge of each apron (see drawing above). Then to match the look of the front trim, chamfer the top outside edge of each apron, like you see in detail 'a.'

BASE PANEL. The next step is to cut the *base panel* (M) to final size. Then cut a rabbet along each edge of the panel, sneaking up on the fit until the tongue just slips into the grooves you cut in the aprons.

To complete the base, all you need to do is miter each apron piece,

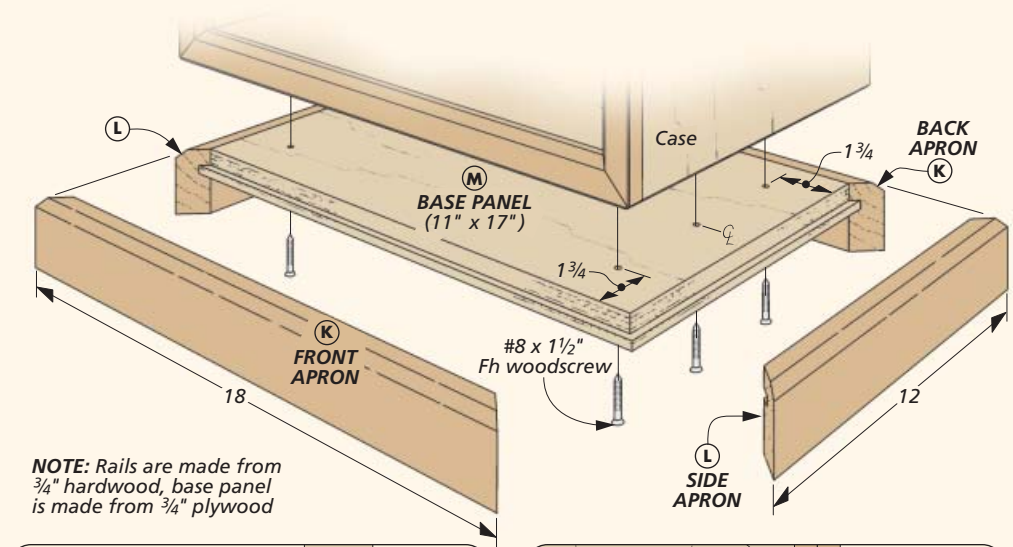

NOTE: Rails are made from $\frac{3}{4}$ " hardwood, base panel is made from $\frac{3}{4}$ " plywood

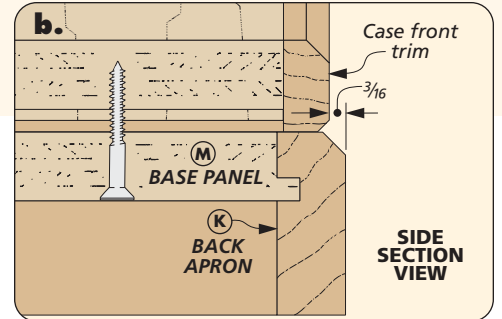
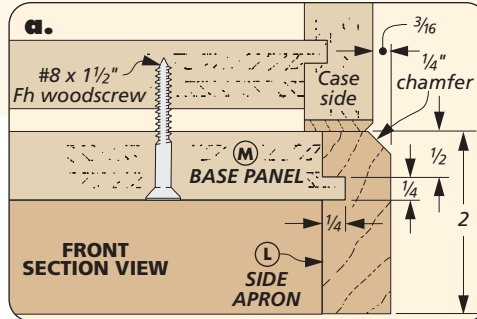

“wrap” it around the base panel, and then glue it in place.

ATTACH THE BASE. Attaching the base to the case is just a matter of screwing it from the bottom, as shown in details 'a' and 'b' above. Just don't tighten the screws too much. Since you don't need the positioning plates for the wine rack, tightening the screws too much can pull the bottom down and bow the case.

ADD THE BACK. All that's left to complete the wine rack is to cut the *back panel* (N) to size from $\frac{1}{4}$ " plywood. The back is held in place with screws, but no glue. This way, you can remove it any time you'd like.

APPLY THE FINISH. Before attaching the back, you'll want to apply a finish to all the parts first. Once that's complete, reassemble the dividers and slip it in place (see photo below). Finally, screw the back on and you're ready to slip your wine bottles in place — and maybe even relax with a glass of your favorite. **W**

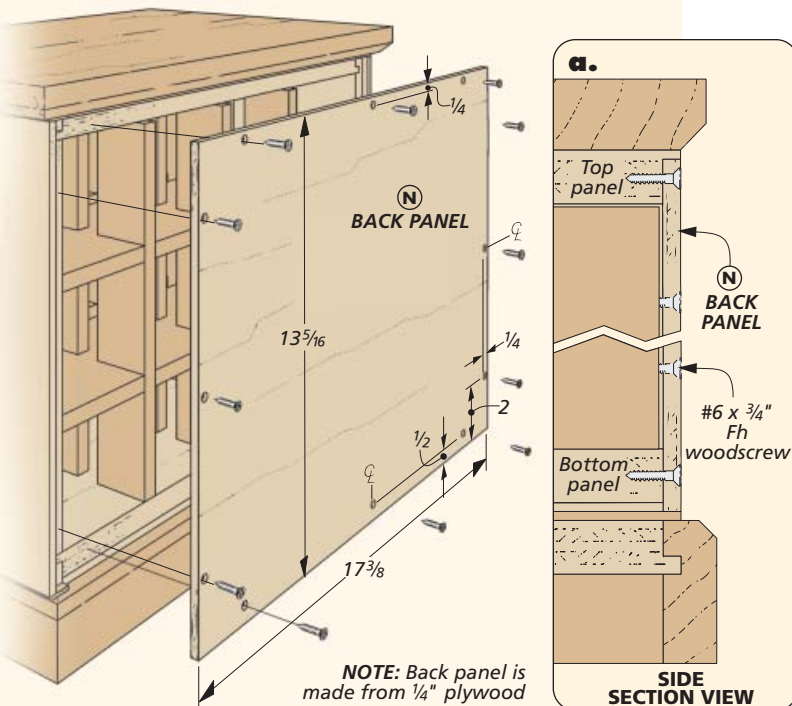

NOTE: Back panel is made from $\frac{1}{4}$ " plywood



▲ **Installing the Dividers.** Since the dividers are not glued together it's easy to apply the finish. And after assembly, they slide straight into the case from the back.

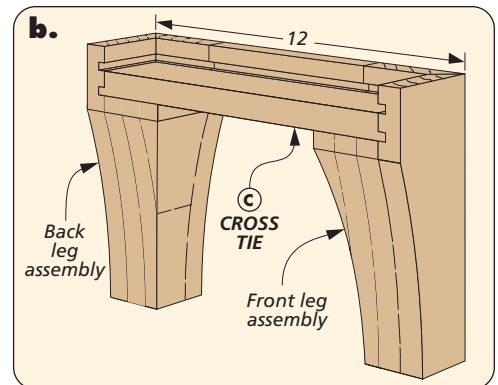
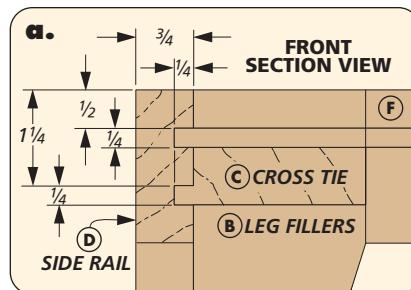
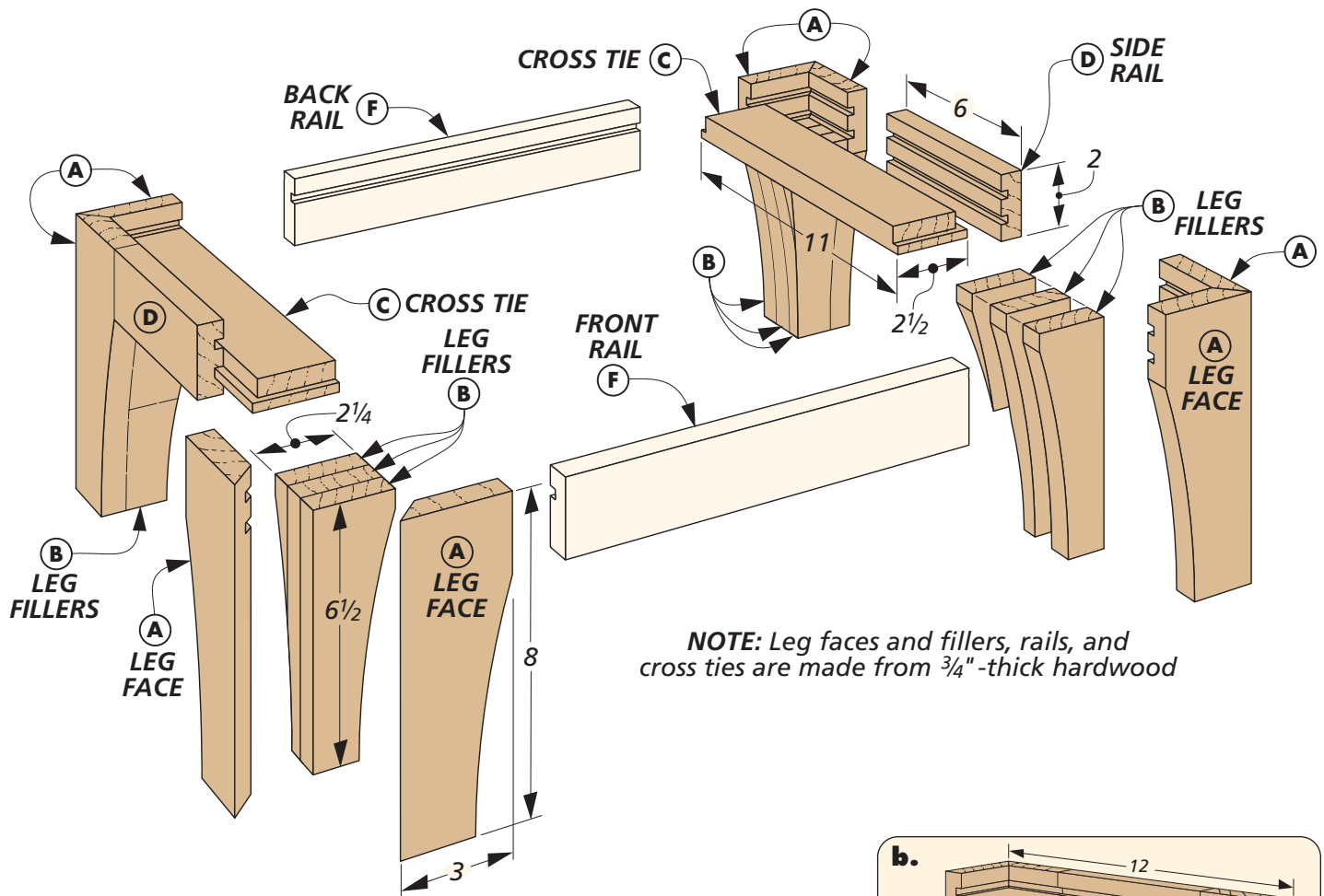

building the **KNOCK-DOWN BASE**

Although the main parts of the wine server are the two plywood cases, the real key to this modular system is the knock-down base.

As I mentioned before, everything about this project is designed to let you customize it any way you want — and still be able to change it later. The base is no exception. If you take a look at the drawing above, you can see that this is no ordinary construction.

The advantage of the base is, if you want to convert the server into something larger

down the road, you can. All you'll need to do at that point is make a set of long rails and a new base panel.

Before tackling the base, it's a good idea to build the cases and top. This way, you can fine-tune the base for a perfect match. To build those, take a look at the detailed instructions on page 3.

The challenge to building the base is to make it sturdy when it's assembled, and still be easy to take apart. To do that, I built the base in three sections — two hardwood

ends, and a plywood middle section. All it takes to disassemble it is to remove a few screws.

END ASSEMBLIES. Depending on the size of the project, the base will have to support a fair amount of weight. That's the job of the ends. The parts that make up each end interlock for solid support.

HEAVY-DUTY LEGS. It starts with the legs, as you can see in the drawing on page 7. The outside faces of the legs are mitered around a thick filler. To see how the legs are made, see page 9.

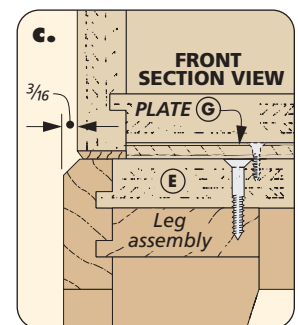
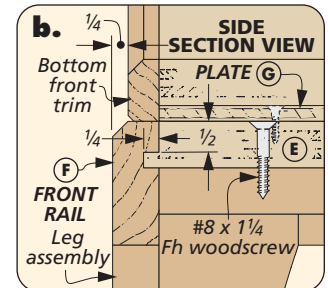
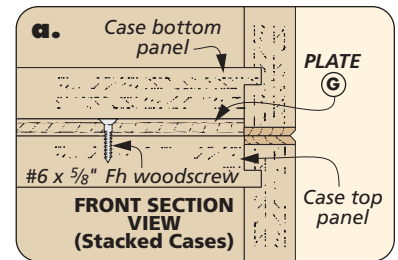
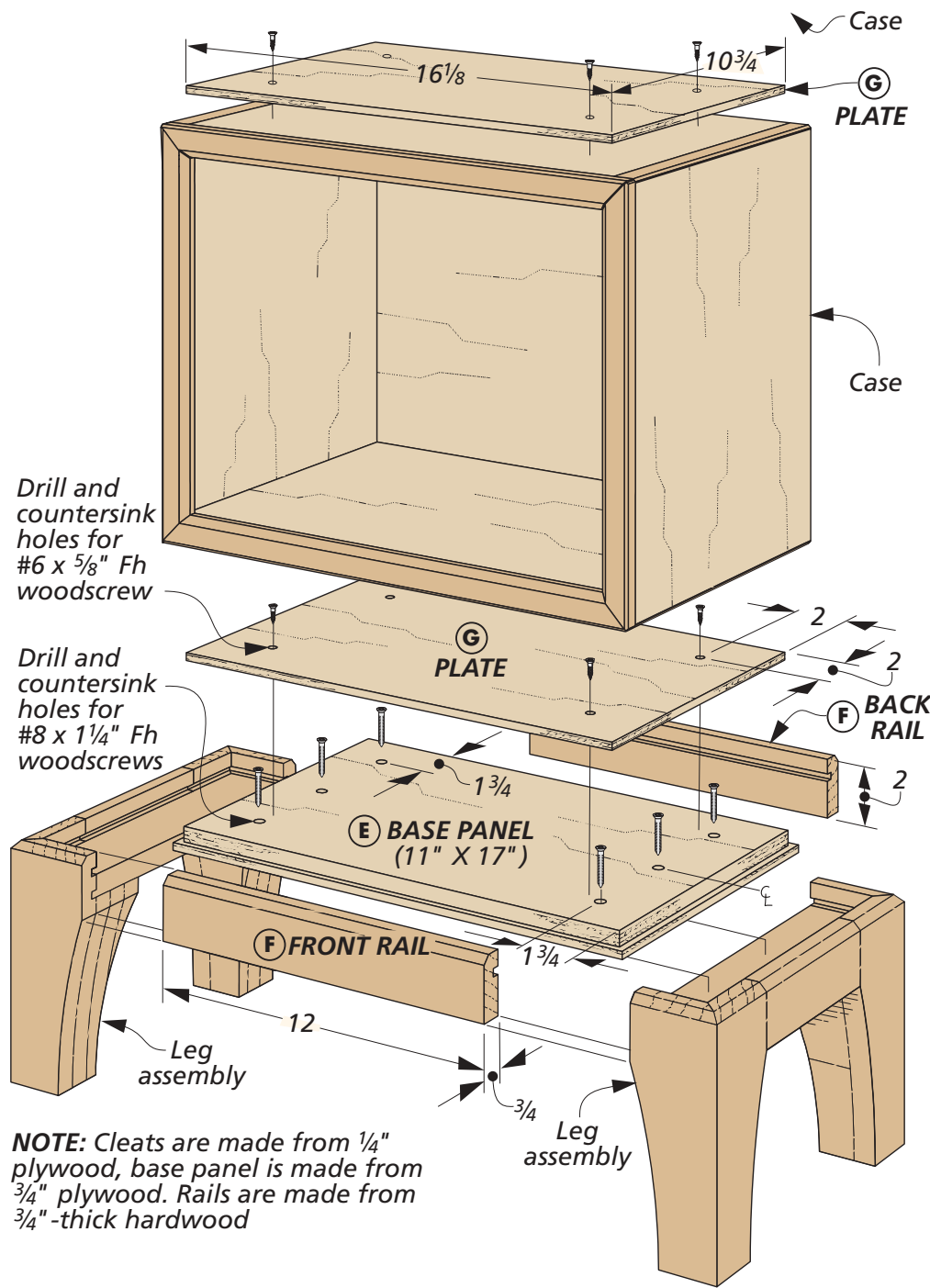

Connecting the legs at each end is a cross tie that slips into dadoes cut in the leg faces. A side rail is then glued to the cross tie (details 'a' and 'b' on the opposite page). The result is a rigid unit that won't flex under pressure. All that remains for the base is to connect the two end assemblies.

COMPLETING THE BASE. The way the ends are joined is similar to the way the legs are connected to each other. But there's an impor-

tant difference. It starts with a plywood panel that has tongues cut along all four edges to fit in the upper dado cut in the legs, as shown in details 'b' and 'c' at right.

The difference is that instead of gluing the plywood panel in place, I attached it with screws, as you can see in the drawing. Using screws makes the base easy to take apart and reuse for a larger project in the future. (All you need to make is a larger ply-

wood panel and new front and back rails.)

The front and back edges of the base are covered by a pair of hardwood rails. Besides covering the plywood edges, the rails prevent the base from sagging. Just be sure to glue the rails to the base only.

ASSEMBLY. Now stack the cases on the base. To keep them from sliding around, I screwed a 1/4" plywood plate to both the base and lower case (details 'a' and 'b').

How-To: Leg Construction

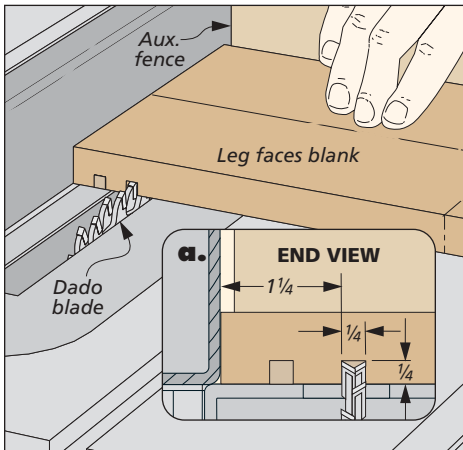

Cut Dados. On an extra-large blank (four leg faces per blank), cut dados for the cross tie. This will ensure the dados will line up.

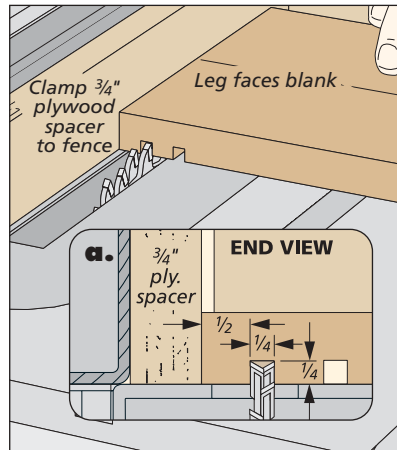

Top Dado. Without changing the fence, insert a plywood spacer to cut the upper dado for the base panel.

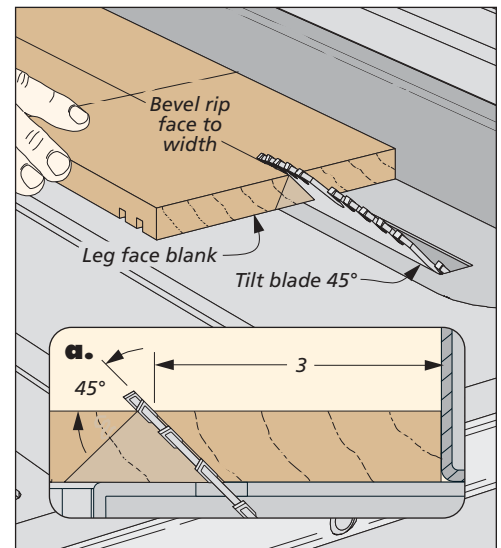

Bevel the Blank. Angle the blade 45° to rip the faces to size. After making one cut, flip the piece end for end and make the second cut.

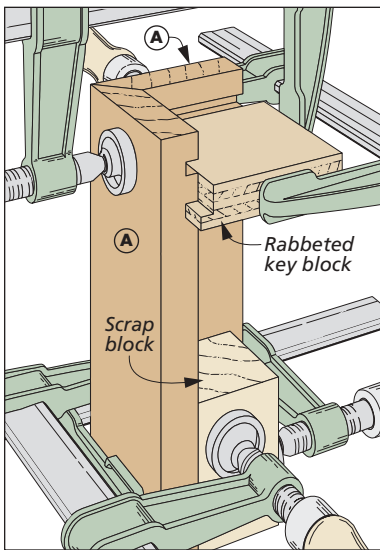

Glue up Leg Faces. A waxed, rabbeted key and spacer keeps the leg faces square as they are glued up.

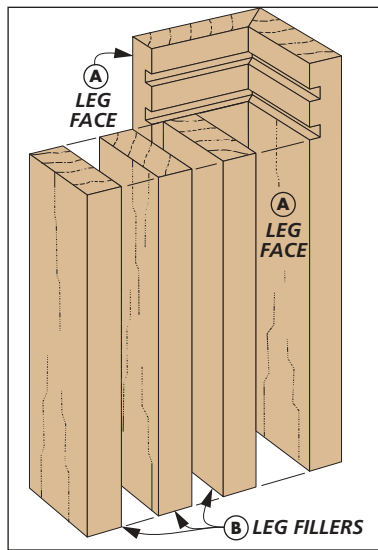

Glue in Leg Fillers. Next, glue leg fillers to the faces to complete the blank. Then square up the edges.

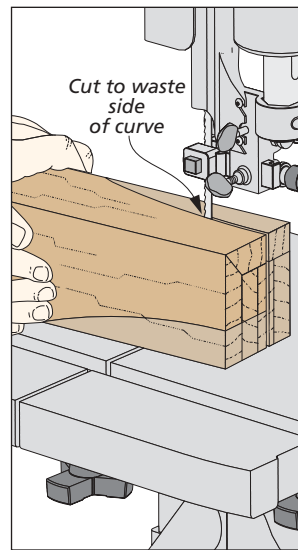

Cut to Shape. Use the template at right to cut the leg to shape, then sand it smooth.

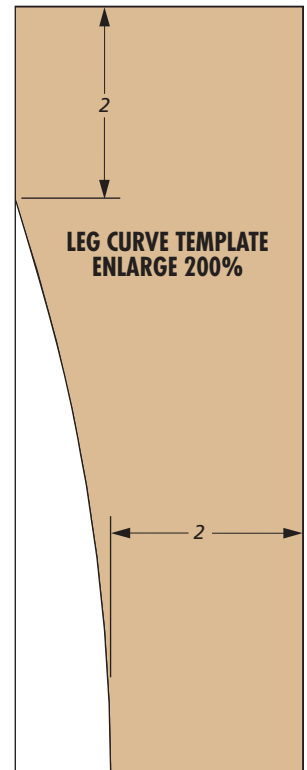

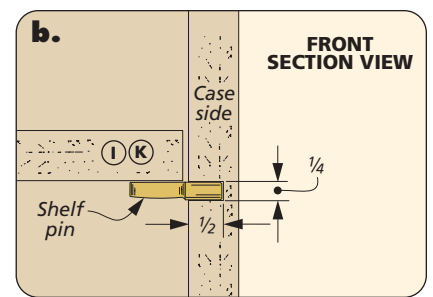
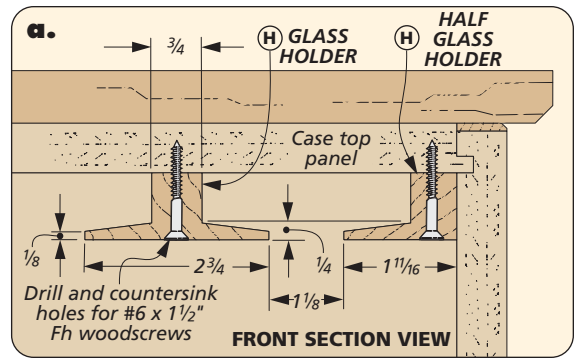
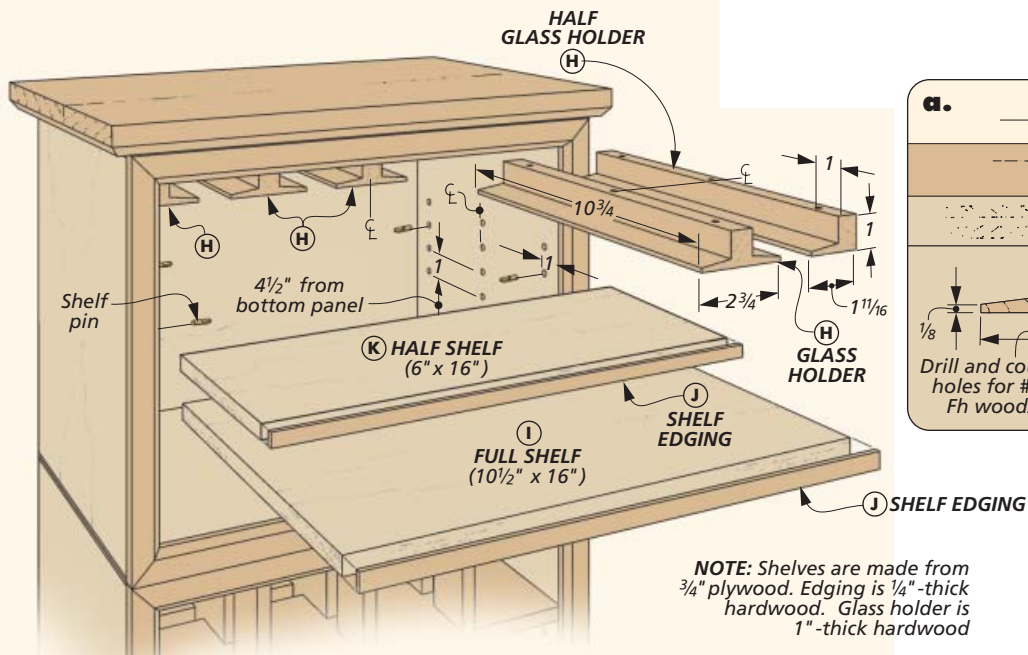

NOTE: Shelves are made from 3/4" plywood. Edging is 1/4"-thick hardwood. Glass holder is 1"-thick hardwood

SHELF OR GLASS HOLDERS

Now that the base is complete, all that remains is to outfit the inside of the cases. In addition to the wine bottle divider shown on page 5, the drawings on this page show you four other options — wineglass holders, two different shelves, and a drawer. Since the backs of the cases are only screwed on, it's easy to install one option and switch to another down the road.

WINEGLASS HOLDERS. The wineglass holders are designed to cradle the base of the glasses, as in detail 'a' above. Making the holders is a simple table saw task. To find out how, turn to page 11. Pre-made holders are also available at Rockler (#22210).

TWO SHELVES. The second option to consider is adding a shelf. But in order to do that, you'll need to drill some holes in the case to

hold the shelf support pins. I drilled three columns of holes to accommodate two shelf sizes. In the drawing above, you can see each shelf is nothing more than a small plywood panel with some edging.

Finally, you can add a drawer, which is detailed below. **W**

Option: Hanging Drawer

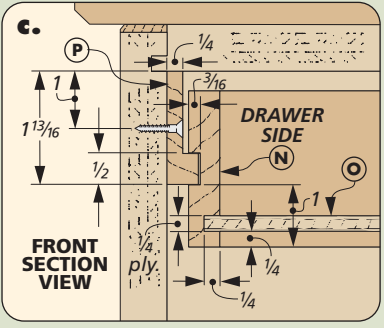
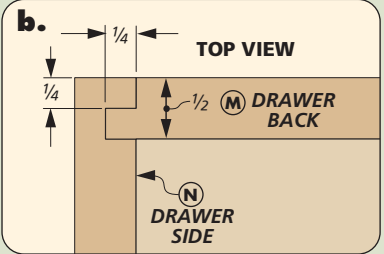
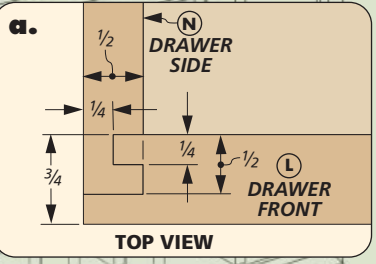
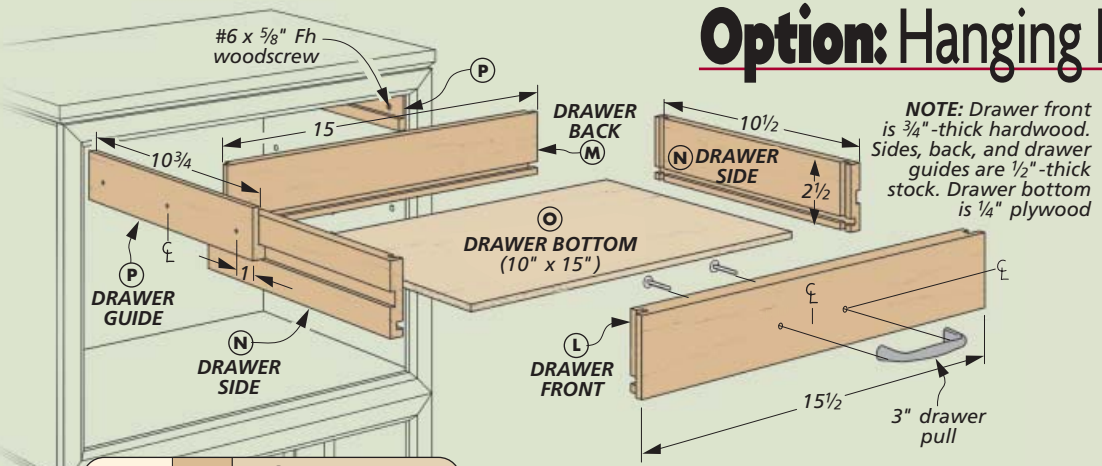

For the wine server, I built a pretty simple drawer box with a sturdy, locking rabbet at the front and simpler, tongue and dado at the back (details 'a' and 'b'). Before assembling the drawer, I cut a centered groove in each side. The sides ride on drawer guides that have a lip along the bottom edge, as shown in detail 'c.' Once installed, the guide is hidden by the case's front trim.

tips from our shop **Making the Hangers**

Although you can buy wineglass hangers from commercial sources, you are limited in the choices of wood the hangers are made from. Since our cabinet was built out of cherry, we decided to make our own hangers out of cherry to match.

NO JIG REQUIRED. As you can see in the “How-To” section below, all that’s really required to make both the single-sided and the double-sided hangers — other than some 1”-thick stock — is a table saw.

My goal was to make the angles of the hangers fit the wineglass stemware. First, I set my table saw fence, raised the saw blade to the right height, and angled the blade, as you can see in detail ‘a’ below. I then ran all the stock through.

After the first cuts were made, I flipped all but two of the stock pieces end over end

and ran them through the saw setup again. The remaining two stock pieces will eventually become the end hangers (thus, single-sided), so they only need one side cut.

I then lowered the blade and re-set the angle to 90°. After adjusting the fence, I ran all the stock through to remove the waste. Then, I turned all but the two end pieces around and ran them through this saw setup (see middle drawing below). Be careful not to put too much pressure alongside the fence, or the blank might tip and lift off the saw table.

SAFETY NOTE. When removing waste from a “notch” type of cut, make sure the waste is on the outside of the saw blade (see middle drawing below). Otherwise, the waste may get pinched between the saw blade and the fence and shoot back at you like a missile.



CUTTING END HANGERS. You can’t just cut a two-sided hanger down the middle to get the end pieces, because you wouldn’t have enough wood to drive a screw into it. To complete the end pieces, I set the saw fence to cut away the waste off the center line, as in the drawing below on the far right.

How-To: Wineglass Hangers

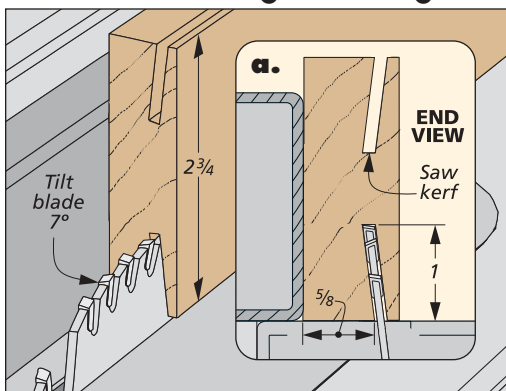

Taper Cut. Set the fence at $\frac{5}{8}$ " and raise the blade to 1" high and at a 7° angle to make the first cuts for the wineglass hangers.

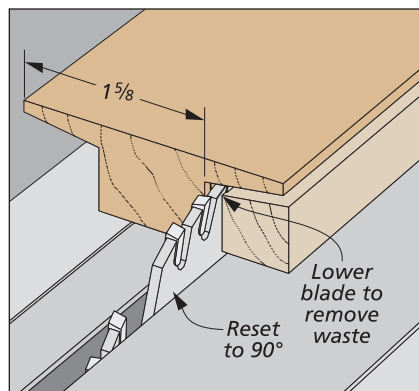

Remove the Waste. Avoid pinching waste between the blade and the fence, or the waste becomes a potential missile.

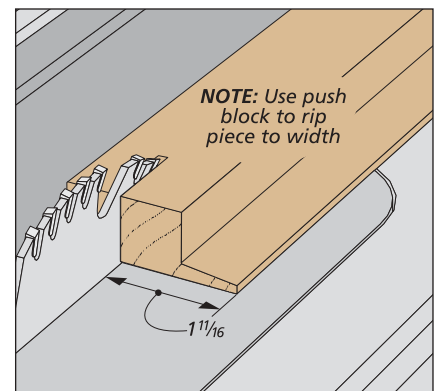

Make End Hangers. The cut to make the end hangers is off-center to give you enough wood to screw into.

Shop Tip: Plane and Simple

Getting dado blades to the correct widths can be frustrating as well as time-consuming. If the cut is not right, you have to take the stack apart and either add or take away shims.

For the dividers in the Wine Rack, I decided to set up the dado first. Once I got the notch right, I then simply planed the divider stock to the appropriate thickness.

I found it much easier to make micro adjustments with my planer than having to add shims to my dado stack. But, remember, don’t get too aggressive in planing the stock, because once the wood is planed off, you can’t put it back.

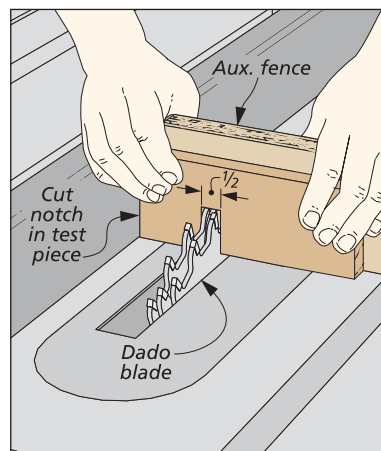

Test Piece. Cut a $\frac{1}{2}$ "-wide dado in a piece of scrap to use as a test piece for planing your divider stock.

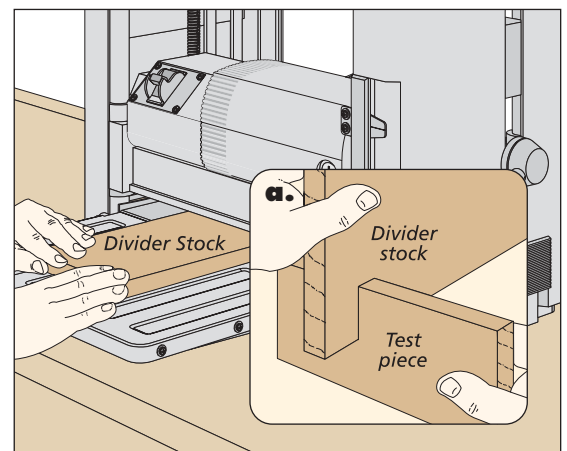

Plane the Stock. Planing the divider stock to a thickness that fits exactly into the notch is easier than creating the notch to fit the stock thickness.



router table Tongue & Groove Joinery

If you're looking for accurate, perfect-fitting tongue and groove joints, discover why the router table is the tool of choice.

Tongue and groove joinery has a lot going for it. It's strong, simple, and you don't need any special equipment to make it. In fact, all you need is a table saw and dado blade.

But just because you *can* make this joint on the table saw doesn't necessarily mean that it's always the best tool for the job. There are times when using a router table makes more sense.

Using the router table to make the same joint has a couple advantages. Unlike a dado blade (which will often leave ridges along the bottom of the groove), a router bit will give you a flat-bottomed groove. So your joints will fit together better and look nicer when the project is assembled.

Second, since router bits are made in standard sizes, there's no messing with dado chippers and shims. If you want a 1/4" groove, you use a 1/4" bit. It's that simple.

PROCEDURE. There's nothing com-

plicated about the process for making tongue and groove joints on the router table. You use a straight bit to plow a groove in the first piece. Then you rout a rabbet on one or both sides of the second piece to create the tongue. That's all there is to it. But to get the best results, there are a few points to go over.

GROOVES. Whether I'm using a table saw or a router table, when it comes to tongue and groove joinery, I'll almost always start with the groove. The reason for this is simple. It's a lot easier to cut all the grooves and then cut the tongues to fit than the other way around.

Cutting the groove (or dado) is the simple part of the equation. All you have to do is select a straight

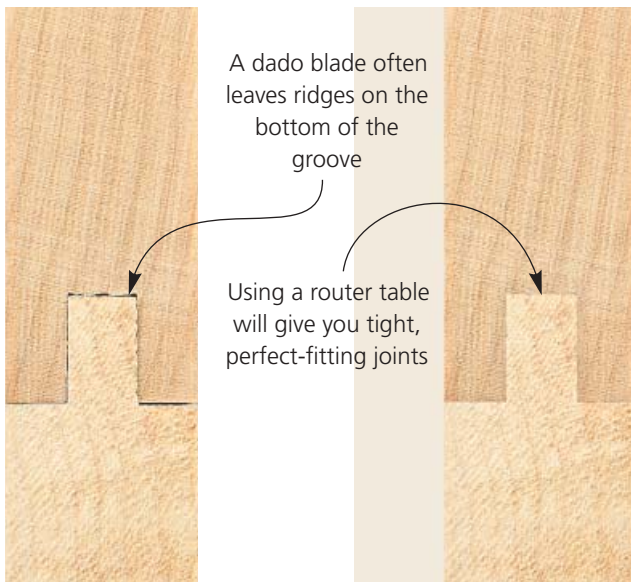

A dado blade often leaves ridges on the bottom of the groove

Using a router table will give you tight, perfect-fitting joints

bit according to the width of the groove you wish to cut. Then use the router table fence to position the groove on your workpiece.

The key is to rout *consistent* grooves on all your workpieces. To do this, hold the workpiece tightly against the fence *and* down on the router table. For grooves deeper than 1/4", you'll need to rout the groove in two or more passes, raising the bit in between each one.

If you want to make a groove that is wider than your bit, you'll need to reposition the fence slightly to make an overlapping cut. This allows you to fine tune the width of your groove to match plywood or other sheet materials.

CHIPOUT. One problem you may have with routing grooves and dados is chipout as the bit exits the wood. To combat this, you can use a backer block, just like you see in the first drawing at right. For routing across narrow workpieces, use a large, square backer block, like the one in the second drawing in the box below. This will help keep the workpiece square to the fence as you push it past the bit.

TONGUE. Once you have the groove routed, the next step is to rout a tongue on the mating workpiece.

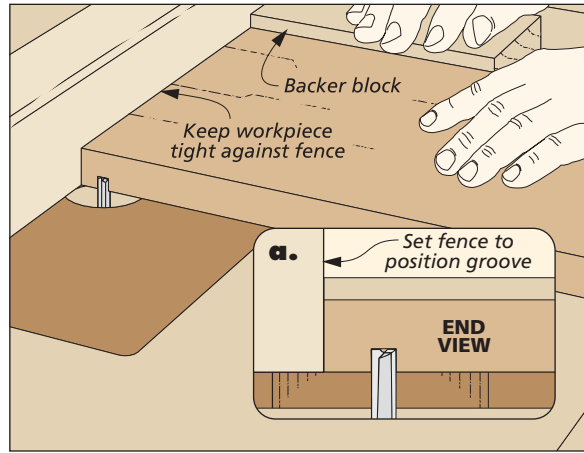

Rout the Groove. To rout a groove (or dado) in an exact spot on a workpiece, use the fence to establish the position of the groove.

Here again, you'll use the router table fence to establish the shoulder(s) of the tongue. But this time, you'll have the straight bit buried in the fence, as shown in the lower drawing at right. (I usually use a 1/2" or 3/4"-dia. bit for making the tongues.)

The trick to getting a good fit is to creep up on the thickness of the tongue by raising the bit slightly between passes. Take your time until you get it right, then go ahead and rout the tongues on all your workpieces for a perfect joint. **W**

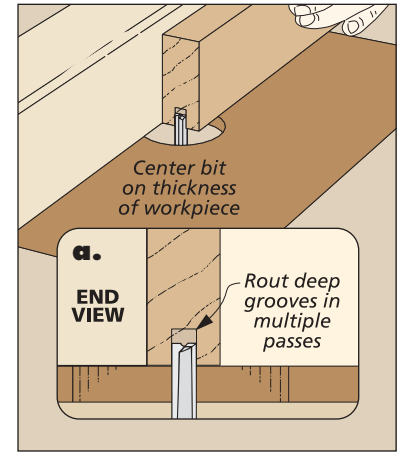

Edge Grooves. To rout a groove on an edge, center the router bit on the thickness of the workpiece.

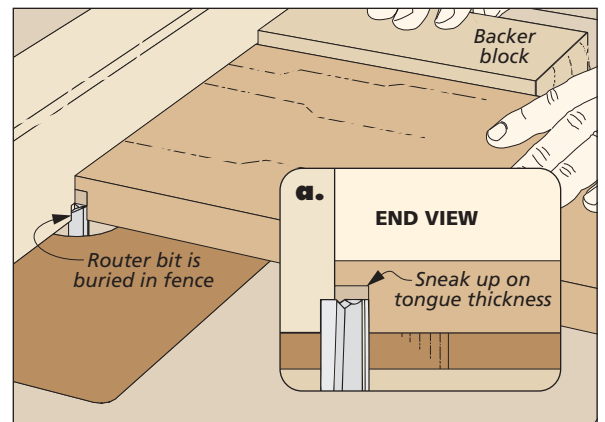

Rout the Tongue. To make the tongue, rout a rabbet along one (or both) faces of the workpiece. Sneak up on the thickness of the tongue until it just fits the groove.

How-To: Beyond Straight Bits

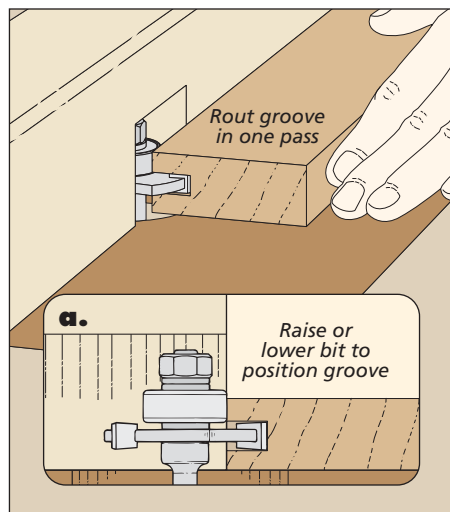

Slot-Cutter Bit. A slot-cutter bit works like a mini saw blade, allowing you to cut a full-depth groove in a single pass.

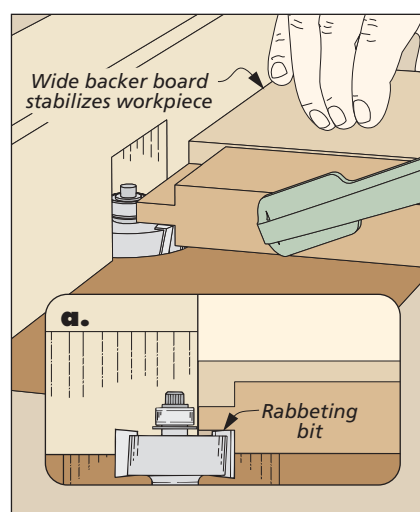

Rabbeting Bit. To make the tongue of the joint, a rabbeting bit is used to rout a rabbet on each side of the tongue.

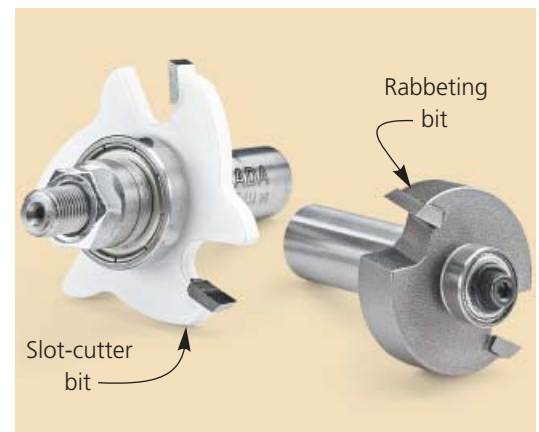

Straight bits work fine for occasional tongue and groove routing. But if you're going to be doing a lot of this type of joinery, you might want to consider investing in a slot-cutter bit and a rabbeting bit. Slot-cutter bits can cut even deep grooves in a single pass, speeding up the time it takes to make the joint. And rabbeting bits make quick work of routing the shoulders to create the tongue.

from server to Wine Buffet

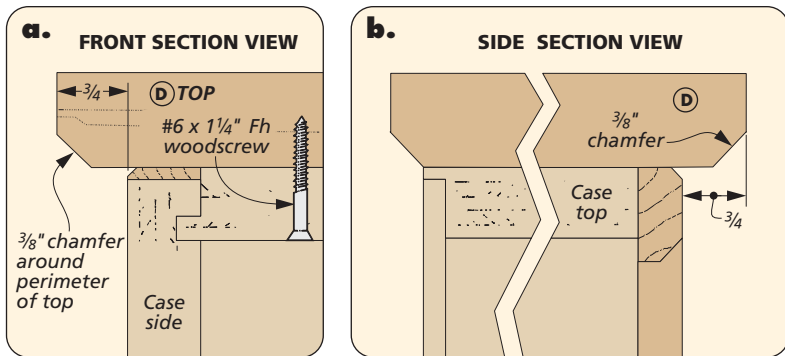

One of the best features of the wine server in Woodsmith No. 157 is that it's modular. Everything from the insides, to the base is designed to be modified and adapted to your needs. A striking way to do this is to triple the size of the server and turn it into a buffet, as you can see in the drawing below and the photo on page 15.

SIMPLE CHANGES. If you choose to go this route, the first order of business is to build four additional cases and plywood plates. Next, you'll need to decide how to lay out the insides of the cases using the wine rack, drawer, glass holders, or shelves shown in the magazine.

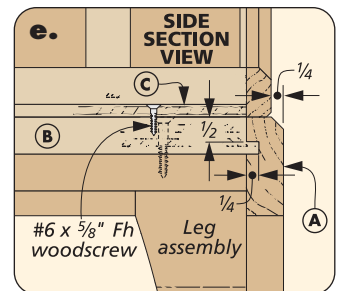
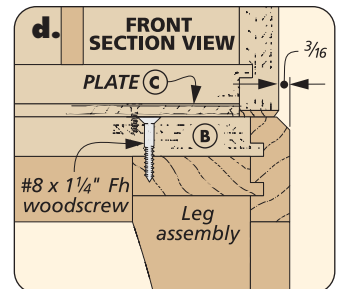
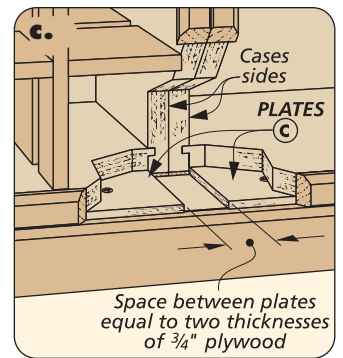
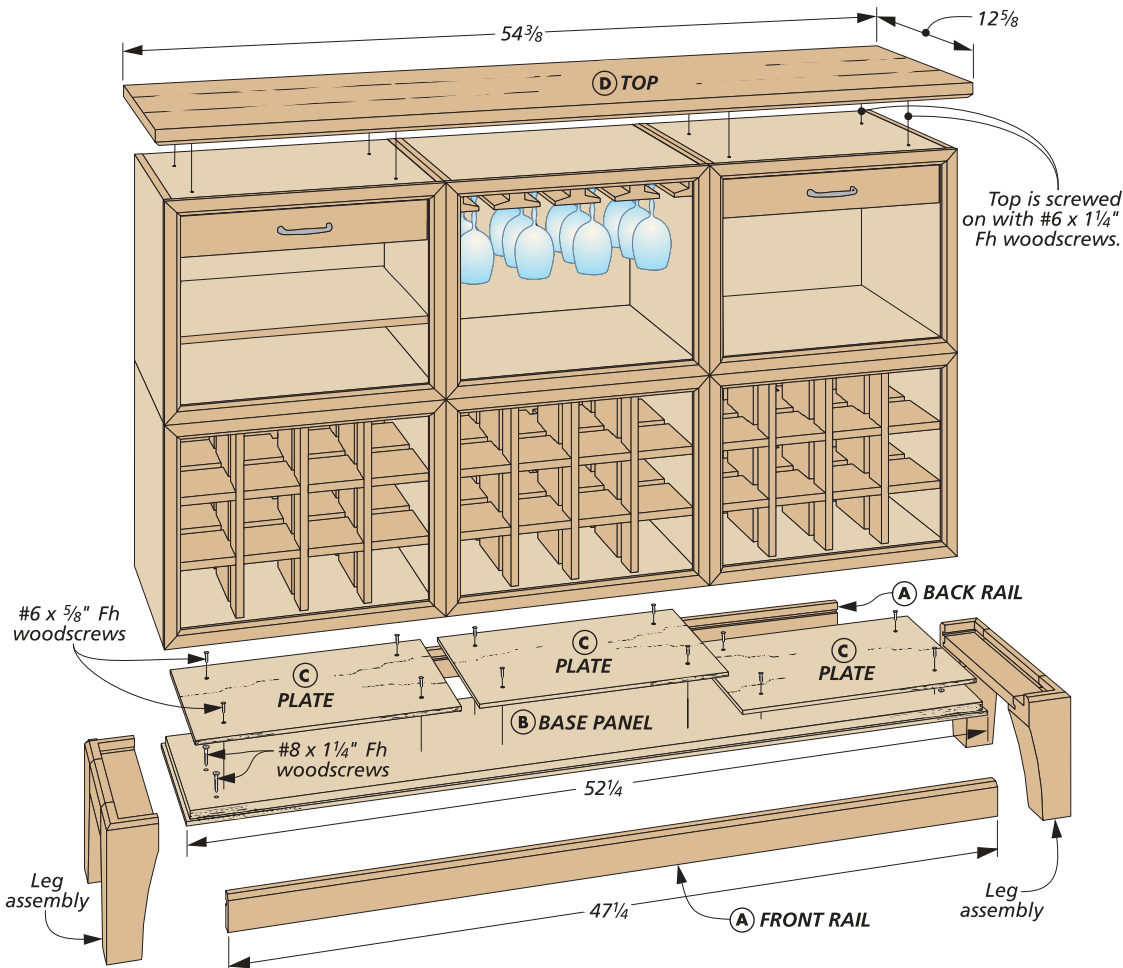

NOTE: Plates keep stacked cases in place

The drawing shows one option, but the choices are almost endless.

EXPANDED BASE. With the extra cases ready to go, you can move on to the base. The ends of the base are identical to those shown in the article. To connect the two ends you'll need a longer base panel and a longer pair of hardwood rails. The dimensions are shown in the drawing on the previous page.

The base is assembled with screws. And after adding the *plates* (C), you can begin stacking up the buffet (details 'c,' 'd,' and 'e').

COMPLETING THE BUFFET. The final part to make is the top. Other than the size, there isn't anything different from the original design. After gluing up and sizing the top panel, a 3/8" chamfer is routed along the bottom edges, as you can see in detail 'b' on the first page. The top is then screwed in place. **W**



Materials, Supplies, & Cutting Diagram No. 157

Wine Buffet

- | | | |
|----------|---------------------|---|
| A | Front/Back Rail (2) | $\frac{3}{4} \times 2 - 47\frac{1}{4}$ |
| B | Base Panel (1) | $\frac{3}{4}$ ply. - $11 \times 52\frac{1}{4}$ |
| C | Plates (4) | $\frac{1}{4}$ ply. - $10\frac{3}{4} \times 16\frac{1}{8}$ |
| D | Top (1) | $1 \times 12\frac{5}{8} - 54\frac{3}{8}$ |

- (8) #6 x 1 1/2" Fh Woodscrews
- (12) #6 x 5/8" Fh Woodscrews
- (6) #8 x 1 1/2" Fh Woodscrews

$\frac{3}{4} \times 5 \text{''} - 48 \text{''}$ Cherry (1.7 Bd. Ft.)

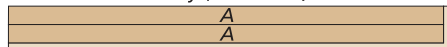

$1 \times 5 \text{''} - 60 \text{''}$ Cherry (Three Boards @ 2.6 Bd. Ft. Each)



$\frac{3}{4} \text{''} - 24 \text{''} \times 96 \text{''}$ Cherry Plywood

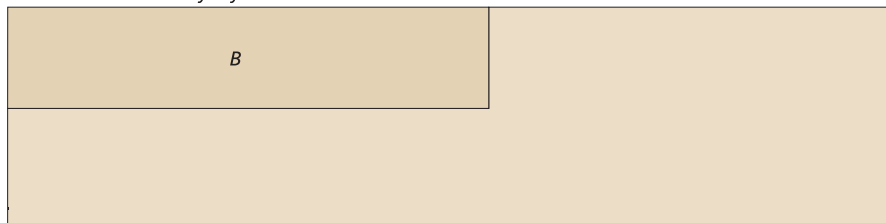

$\frac{1}{4} \text{''} - 24 \text{''} \times 48 \text{''}$ Cherry Plywood

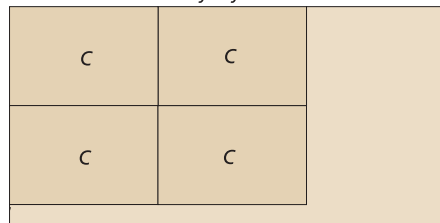

Countertop Wine Rack

A Case Side Panels (2)	$\frac{3}{4}$ ply. - 11 x 13 $\frac{5}{16}$	J Divider Center Vertical Slats (3)	$\frac{1}{2}$ x 4 $\frac{7}{8}$ - 11 $\frac{3}{4}$
B Case Top Panel (1)	$\frac{3}{4}$ ply. - 11 x 16 $\frac{5}{8}$	K Base Front/Back Aprons (2)	$\frac{3}{4}$ x 2 - 18
C Case Bottom Panel (1)	$\frac{3}{4}$ ply. - 10 $\frac{3}{4}$ x 16 $\frac{5}{8}$	L Base Side Aprons (2)	$\frac{3}{4}$ x 2 - 12
D Side Panel Edging (4)	$\frac{1}{8}$ x $\frac{3}{4}$ - 11	M Base Panel (1)	$\frac{3}{4}$ ply. - 11 x 17
E Case Top/Bottom Front Trim (2)	$\frac{1}{2}$ x 1 - 17 $\frac{5}{8}$	N Back Panel (1)	$\frac{1}{4}$ ply. - 13 $\frac{5}{16}$ x 17 $\frac{3}{8}$
F Case Sides Front Trim (2)	$\frac{1}{2}$ x 1 - 13 $\frac{9}{16}$	• (6) #8 x 1 $\frac{1}{2}$ " Fh Woodscrews	
G Top (1)	1 x 12 $\frac{5}{8}$ - 19 $\frac{1}{8}$	• (12) #6 x $\frac{3}{4}$ " Fh Woodscrews	
H Divider Front/Back Vertical Slats (6)	$\frac{1}{2}$ x 2 - 11 $\frac{3}{4}$		
I Divider Horizontal Slats (4)	$\frac{1}{2}$ x 4 $\frac{7}{8}$ - 16		

$\frac{3}{4}$ " x 6 $\frac{1}{2}$ " - 72" Cherry (3.3 Bd. Ft.)

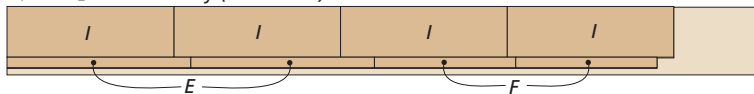

$\frac{3}{4}$ " x 5" - 36" Cherry (1.3 Bd. Ft.)

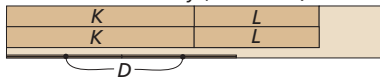

$\frac{3}{4}$ " x 6 $\frac{1}{2}$ " - 60" Cherry (2.7 Bd. Ft.)

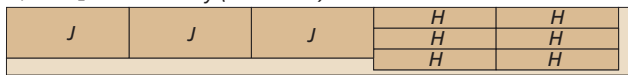

1" x 5" - 60" Cherry (2.6 Bd. Ft.)



$\frac{3}{4}$ " - 24" x 48" Cherry Plywood

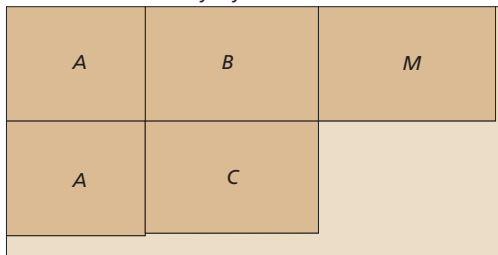

$\frac{1}{4}$ " - 24" x 24" Cherry Plywood

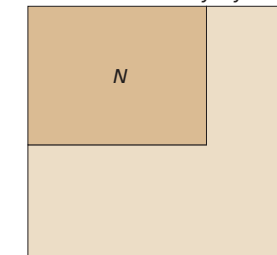

Modular Wine Server

A Leg Faces (8)	$\frac{3}{4}$ x 3 - 8	M Drawer Back (1)	$\frac{1}{2}$ x 2 $\frac{1}{2}$ - 15
B Leg Fillers (12)	$\frac{3}{4}$ x 2 $\frac{1}{4}$ - 6 $\frac{1}{2}$	N Drawer Sides (2)	$\frac{1}{2}$ x 2 $\frac{1}{2}$ - 10 $\frac{1}{2}$
C Cross Ties (2)	$\frac{3}{4}$ x 2 $\frac{1}{2}$ - 11	O Drawer Bottom (1)	$\frac{1}{4}$ ply. x 10 - 15
D Side Rails (2)	$\frac{3}{4}$ x 2 - 6	P Drawer Guides (2)	$\frac{1}{2}$ x 1 $\frac{13}{16}$ - 10 $\frac{3}{4}$
E Base Panel (1)	$\frac{3}{4}$ ply. x 11 - 17	• (6) #8 x 1 $\frac{1}{4}$ " Fh Woodscrews	
F Front/Back Rails (2)	$\frac{3}{4}$ x 2 - 12	• (8) #6 x $\frac{5}{8}$ " Fh Woodscrews	
G Plates (2)	$\frac{1}{4}$ ply. x 10 $\frac{3}{4}$ - 16 $\frac{1}{8}$	• (6 Per Optional Drawer) #6 x $\frac{5}{8}$ " Fh Woodscrews	
H Glass Holders (5)	1 x 2 $\frac{3}{4}$ - 10 $\frac{3}{4}$	• (15) #6 x 1 $\frac{1}{2}$ " Fh Woodscrews For Glass Holders	
I Full Shelf (1)	$\frac{3}{4}$ ply. x 10 $\frac{1}{2}$ - 16	• (4 Per Optional Shelf) $\frac{1}{4}$ " Spoon-style Shelf Pins	
J Shelf Edging (1 Per Shelf)	$\frac{1}{4}$ x $\frac{3}{4}$ - 16	• (1 Per Optional Drawer) 3" Drawer Pull w/Screws	
K Half Shelf (1)	$\frac{3}{4}$ ply. x 6 - 16		
L Drawer Front (1)	$\frac{3}{4}$ x 2 $\frac{1}{2}$ - 15 $\frac{1}{2}$		

$\frac{3}{4}$ " x 7 $\frac{1}{2}$ " - 60" Cherry (3.2 Bd. Ft.)

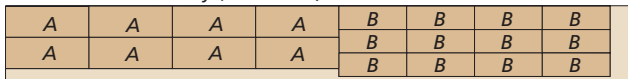

$\frac{3}{4}$ " x 7" - 36" Cherry (1.8 Bd. Ft.)

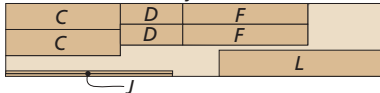

1" x 6" - 36" Cherry (1.9 Bd. Ft.)

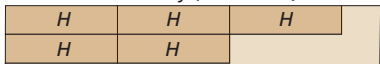

$\frac{1}{2}$ " x 3" - 60" Cherry (1.3 Sq. Ft.)



$\frac{3}{4}$ " - 24" x 48" Cherry Plywood

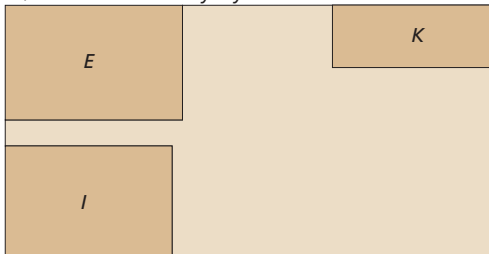

$\frac{1}{4}$ " - 24" x 48" Cherry Plywood

