

straight-tracking crosscut sled

For cutting long or wide stock on your tablesaw, this simple jig is like having another pair of hands.



With a long, wide base securely anchored to a 20"-long miter-gauge slot guide bar, this crosscut sled provides a lot more workpiece support than a standard miter gauge. And it's so inexpensive and easy to build that every tablesaw should have one. Here's how to make yours.

Start with the guide bar. To make it, joint one edge of a 3/4"-thick board 24" long, and then rip a 1 3/16"-wide strip from it. (We used maple.) Adjusting your planer to just shave the surface, reduce the 1 3/16" width in multiple passes until the piece slides in your tablesaw miter-gauge slot without play. Now rotate the piece 90° and plane the original 3/4" thickness to 3/8". Trim the guide bar to 20" long, and sand tapers on the front end, where shown on the drawing at right.

From 1/2" plywood or medium-density fiberboard, cut the 14x24" base. With a 1/8" dado blade, cut a 1/8"-deep dado in the base, 6" from one end. Then moving the rip fence in small increments, widen the dado until

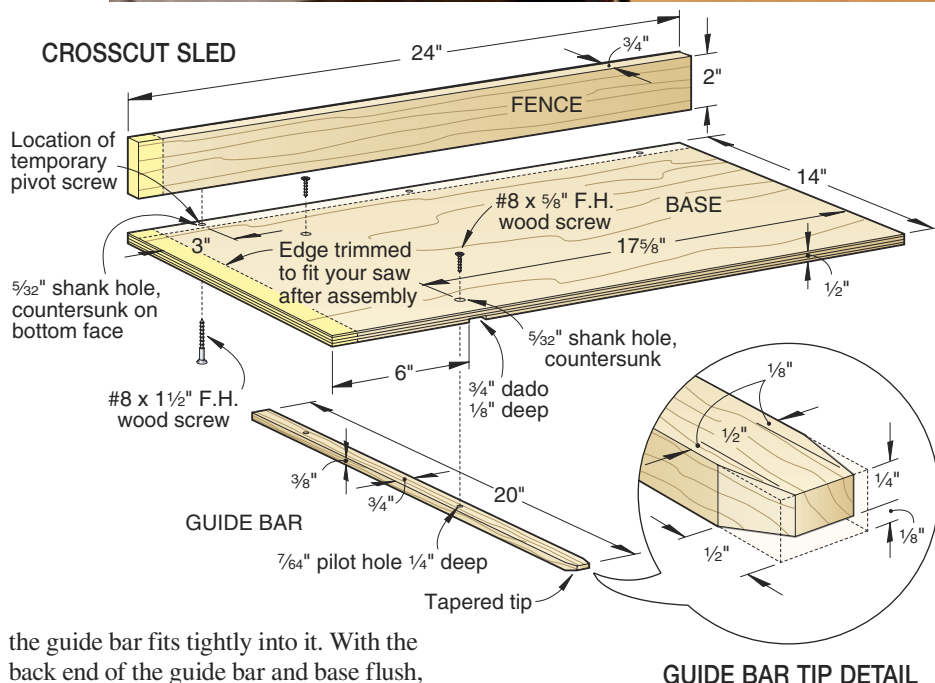

the guide bar fits tightly into it. With the back end of the guide bar and base flush, drill countersunk screw holes and fasten the guide bar into place.

continued on page 98

THREE STEPS TO PERFECT 90° CROSSCUTS



Square the fence to the end of the base and secure the free end with a clamp.

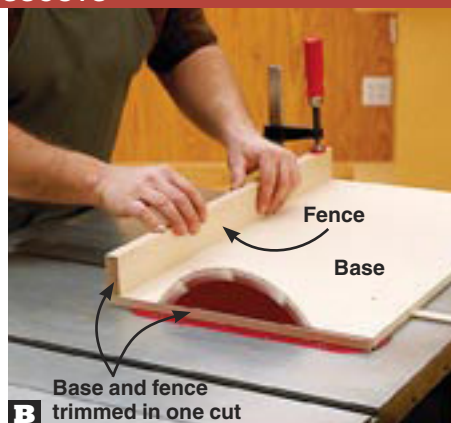

With the guide bar riding in the miter-gauge slot, trim the end of the base and fence.

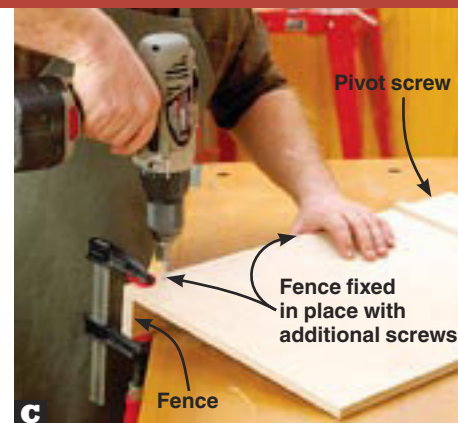

Recheck the fence for square. Then fix the fence position with two more screws.

quick and easy jig

Cut the $\frac{3}{4}$ ×2×24" fence (any piece of straight and flat stock will do). Clamp it to the base, flush with the ends and back edge. From the bottom, drill a countersunk screw hole for the temporary pivot screw, where shown on the drawing on *page 96*, and drive the screw. Then follow the three steps shown in **Photos A, B, and C** to square the fence to the blade. Now finish-sand the jig and protect it with two coats of finish.

Using the crosscut sled

The jig easily handles unwieldy parts, such as the 11¼"-wide by 43"-long sides of the bookshelf plan **DP-00477a**. To use the sled, simply hold the workpiece down on the base and tight against the fence, as shown in the top photo on *page 96*. Because you trimmed the jig flush with the blade, you can align your cutline with the end of the base. The wide base and extra-long guide bar allow you to start a cut with the fence well off the front edge of the table without sacrificing workpiece support or a square cut. For cutting several pieces shorter than the sled to the same length, clamp a stopblock to the fence where needed. You also can fasten cleats to the base to position hard-to-hold parts for angled cuts, as shown in **Photo D**. 🌲

©Copyright Meredith Corporation 2005

DIFFICULT CUTS MADE EASY

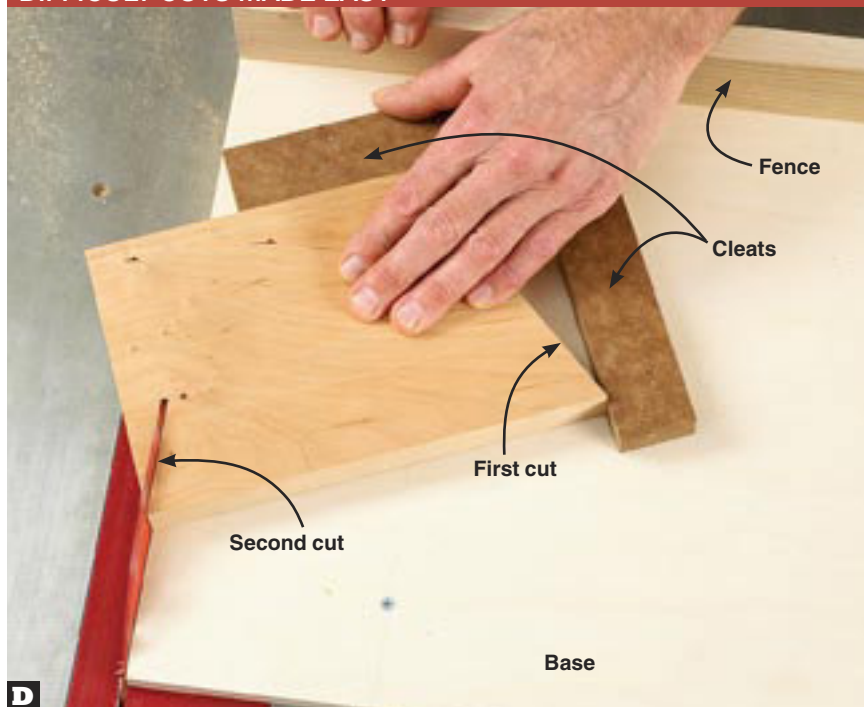

D To position parts for angled cuts, fasten cleats to the base with cloth-backed double-faced tape or drive flathead woodscrews from the bottom.